

Metodos de aberturas para los módulos de cocina

OPENING METHODS

Aberturas

GRIP RECESS / Cola

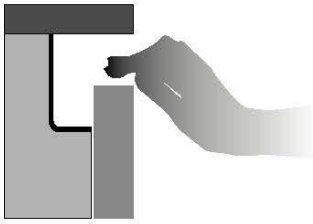

J - SHAPED GRIP
Cola "J"

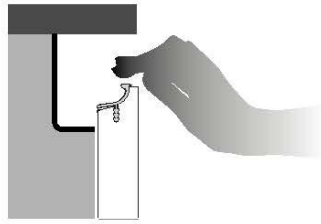

J PRO - SHAPED GRIP
Cola "J PRO"

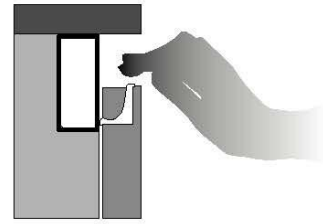

STRAIGHT GRIP WITH RECESSED HANDLE
Perfil "Plano" con manilla embutida

PUSH - PULL

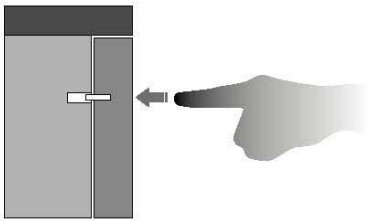

HANDLE / Manilla

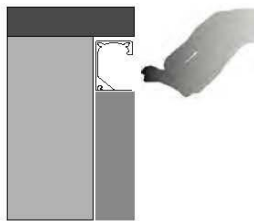
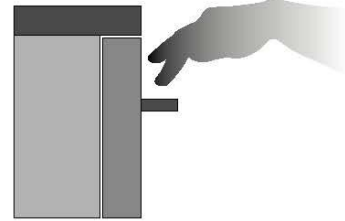

"PRESA"

HANDLE / Manilla

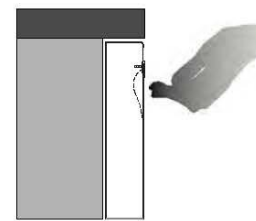

"F1" CARRERA

HANDLE / Manilla